

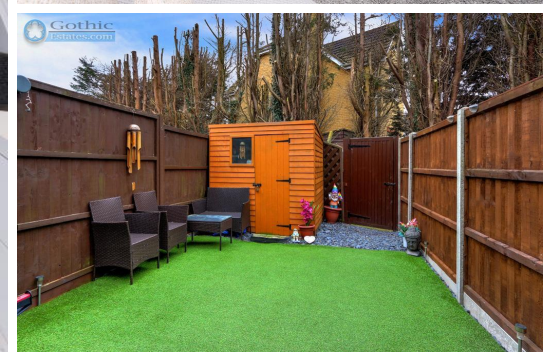

1 Bed Terraced in Lamb Meadow, Arlesey, SG15 6RY | £1

Gothic

Estates.com



Key Features

- Extended one bedroom home
- Fabulous Kitchen and decor throughout
- Separate Living & Dining Rooms
- South-facing fenced garden
- Parking space + 1 smaller car on front
- Double glazed & gas central heating
- Generous double bedroom
- See WALK-THROUGH VIDEO here...

Description

SOLD SOLD SOLD

* EXTENDED starter home * Separate Living & Dining Rooms * FABULOUS KITCHEN * 2 car parking * Lovely decor throughout - READY TO MOVE IN * Gas rad heating + double glazing * SOUTH-FACING private garden * See WALK-THROUGH VIDEO here....

This 1 bedroom home has a rear addition to provide fantastic extra living space - it now has Living Room, Kitchen AND Dining Room. The whole place has been much improved and upgraded by the owners and represents an ideal ready-to-go opportunity for first time buyers & downsizers.

The house is situated at the end of a cul-de-sac and has both an allocated parking space and the opportunity to park a second smaller vehicle on the frontage. The back garden is fully enclosed, has a back gate and is not overlooked from the rear. It requires minimal maintenance with artificial turf and there's a useful garden shed.

Inside downstairs, an entrance hall with coats/boots cupboard leads into the Dining Room which is open plan onto the kitchen. The kitchen is re-fitted in a tasteful modern style with built-in double oven. To the rear is the brick/double glazed addition providing the Living Room with double doors out to the garden. Upstairs there's a landing (with window) bathroom (also with window) and a generous double bedroom with a dormer window to the front. The airing cupboard now houses the Logic combi boiler. Next to the airing cupboard is wall space ideal for wardrobe installation.

The property is about 5 minutes walk from Arlesey's main local shops and also about 5 minutes walk to country trails to the west along the Buttercup Meadow / Hicca Way / River Purwell and to the east along West Drive toward Fairfield Park and the lagoons. Arlesey mainline train station is 1.7 miles (about half hour walk or 6 mins by car)

Please review all available location and property information before booking physical viewing.

Location

Arlesey is a large village just North of the Beds/Herts border, surrounded by countryside yet within easy reach of the A507 and A1(M). The village offers a range of local shopping, pubs and food outlets and significantly a Mainline Railway station with direct travel to London St. Pancras in under 40 minutes. Dating back as long as the 1086 Domesday Book, there is a broad range of home styles and building eras - something for everyone! Gothic Mede Academy provides Primary education in the middle of the village, with numerous Secondary options including Etonbury Academy on the Arlesey/Stotfold border. Further facilities and shopping are available within a few miles in the larger towns of Letchworth Garden City and Hitchin to the South.





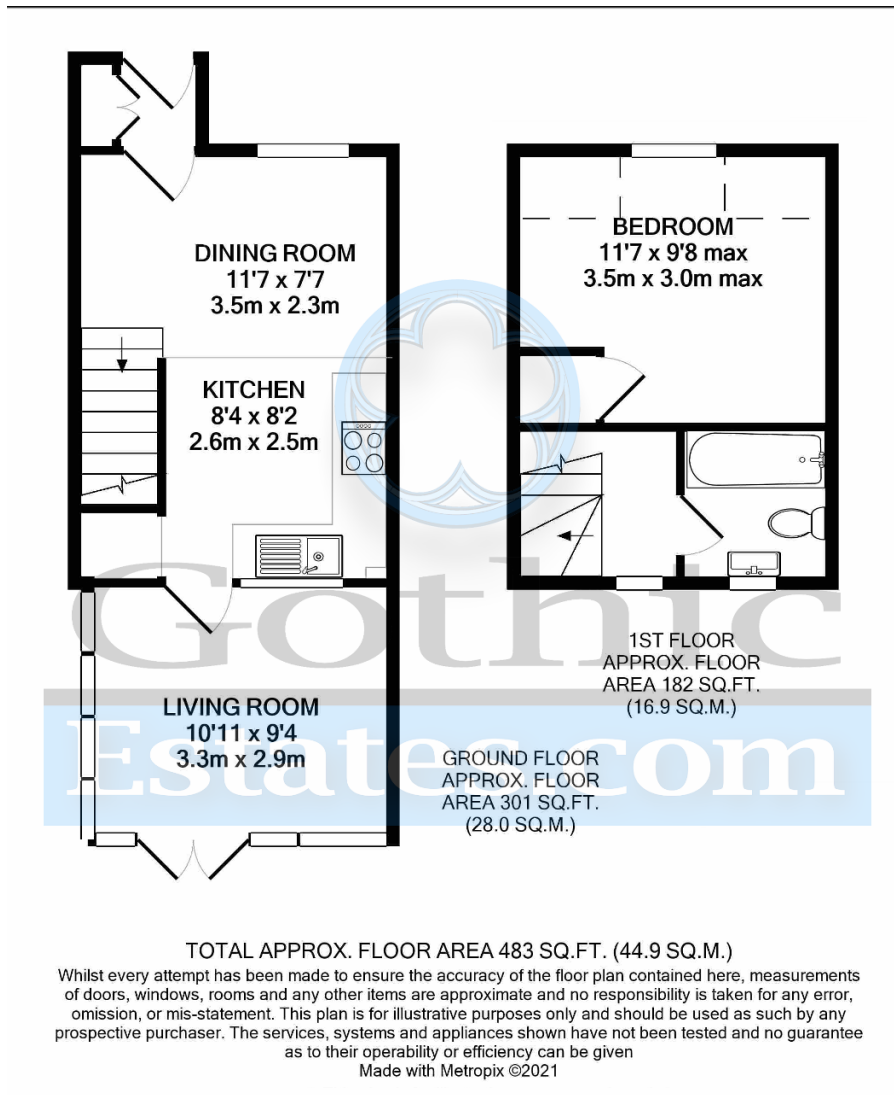

Energy Efficiency

Energy Efficiency Rating			
Score	Energy rating	Current	Potential
92+	A		
81-91	B		91 B
69-80	C	70 C	
55-68	D		
39-54	E		
21-38	F		
1-20	G		