



2 Bed Bungalow detached in Primrose Lane, Arlesey, SG15 6RD | £1

Gothic

Estates.com

Estates.com



Key Features

- Huge renovation completed!
- Link detached bungalow with garage
- Extensive upgrades throughout
- Two double bedrooms with wardrobes
- Large reception with wood burner
- Shaker kitchen + Granite + Appliances
- Large bathroom: bath + separate shower
- No-through road near village shops

Description

SOLD SOLD SOLD

* EXTENSIVE UPGRADES * Detached Bungalow in no-through road *
Two double bedrooms * Fabulous kitchen with GRANITE +
APPLIANCES * Large reception with WOOD BURNER FIREPLACE *
Huge bathroom with bath & sep shower * Attached GARAGE +
DRIVEWAY parking * See WALK-THROUGH VIDEO here...

Huge amount of work completed in this bungalow in 2017, with much still like new. Upgrades included: re-wired, re-plastered (inc ceilings), new windows, new high-end luxury kitchen, internally expanded new bathroom, new wood burner in reception, new radiators & hot water system (boiler 2016), new flooring/decor.

Accommodation is generous with two double bedrooms (each with built-in wardrobes), very spacious living room with the fireplace, eat-in size Kitchen/Diner and a particularly large bathroom.

The property is situated on a no-through road within a few minutes walk of local shopping (incl. pharmacy). The plot offers good size front and rear gardens, the front garden possible offering the scope for further parking. The garage is attached with driveway parking in front. Back garden enjoys a good degree of privacy with other bungalows on either side.

Local shopping 2-3 mins walk

Arlesey mainline station (direct London St Pancras) 1.5 miles

Letchworth Garden City & station 3.6 miles

Hitchin centre 4.7 miles

Location

Arlesey is a large village just North of the Beds/Herts border, surrounded by countryside yet within easy reach of the A507 and A1(M). The village offers a range of local shopping, pubs and food outlets and significantly a Mainline Railway station with direct travel to London St. Pancras in under 40 minutes. Dating back as long as the 1086 Domesday Book, there is a broad range of home styles and building eras - something for everyone! Gothic Mede Academy provides Primary education in the middle of the village, with numerous Secondary options including Etonbury Academy on the Arlesey/Stotfold border. Further facilities and shopping are available within a few miles in the larger towns of Letchworth Garden City and Hitchin to the South.





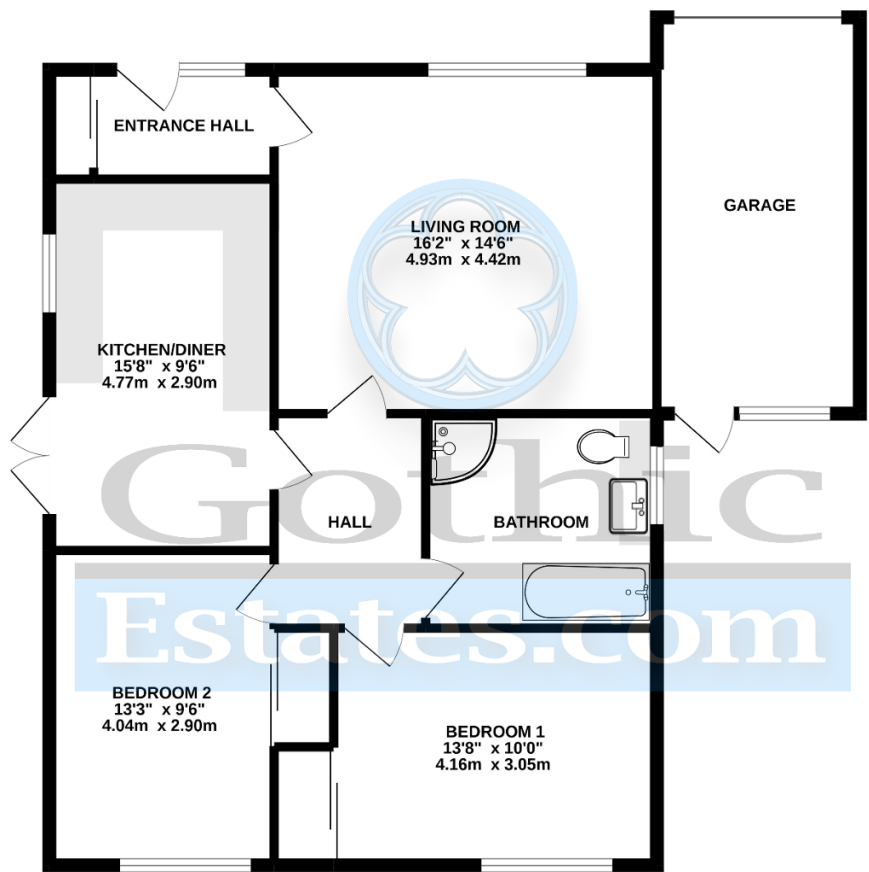

TOTAL FLOOR AREA : 1004 sq.ft. (93.3 sq.m.) approx.

Whilst every attempt has been made to ensure the accuracy of the floorplan contained here, measurements of doors, windows, rooms and any other items are approximate and no responsibility is taken for any error, omission or mis-statement. This plan is for illustrative purposes only and should be used as such by any prospective purchaser. The services, systems and appliances shown have not been tested and no guarantee as to their operability or efficiency can be given.
Made with Metronix 6/2/22

