



3 Bed Semi-Detached in High Street, Arlesey, SG15 6SZ | £1

Gothic

Estates.com

Estates.com



VIDEO



Key Features

- NO CHAIN & about 15 mins walk to station
- Traditional 3 bedroom semi-detached home
- Generous plot, west facing rear garden
- Garage plus Parking for 4+ cars
- Through Living/Dining Room
- Conservatory addition
- UPDATE & RE-DECORATE OPPORTUNITY
- See WALK-THROUGH VIDEO here...

Description

SOLD SOLD SOLD

* CHAIN FREE SALE * About 15 mins WALK TO STATION * Traditional 3 bed semi * Generous plot with west-facing garden * GARAGE plus PARKING for at least 4 cars * DIY Update/Re-decorate opportunity * See WALK-THROUGH VIDEO here....

Excellent size plot for this mature, non-estate 3 bedroom semi which includes a west-facing garden (sun from mid-morning through to sun-down) and a large frontage with a side driveway leading to the garage. Four cars parked easily plus the garage.

Traditional layout with decent bedrooms sizes, through Living/Dining Room and a conservatory added at the back. The property would benefit from updating and re-decoration throughout.

Chain free sale is subject to receipt of probate expected December. Accordingly, earliest completion is most likely in the new year.

Arlesey mainline rail station (direct London St Pancras from 39 mins) 0.9 miles 15-19 mins walk
Gothic Mede Academy (Lower School) 0.1 miles 3 mins walk
Nearest local shop 0.1 miles 3 mins walk
Nearest local pub (thatched with family garden) 0.1 miles 3 mins walk
A1(M) j10 3.7 miles
Letchworth Garden City centre 3.8 miles
Hitchin centre 5.1 miles
Council tax band C

Location

Arlesey is a large, growing village just North of the Beds/Herts border, surrounded by countryside yet within easy reach of the A507 and A1(M). The village offers a range of local shopping, pubs and food outlets and significantly a Mainline Railway station with direct travel to London St. Pancras in under 40 minutes. Dating back as long as the 1086 Domesday Book, there is a broad range of home styles and building eras - something for everyone! Gothic Mede Academy provides Primary education in the middle of the village, with numerous Secondary options including Etonbury Academy on the Arlesey/Stotfold border. Further facilities and shopping are available within a few miles in the larger towns of Letchworth Garden City and Hitchin to the South.



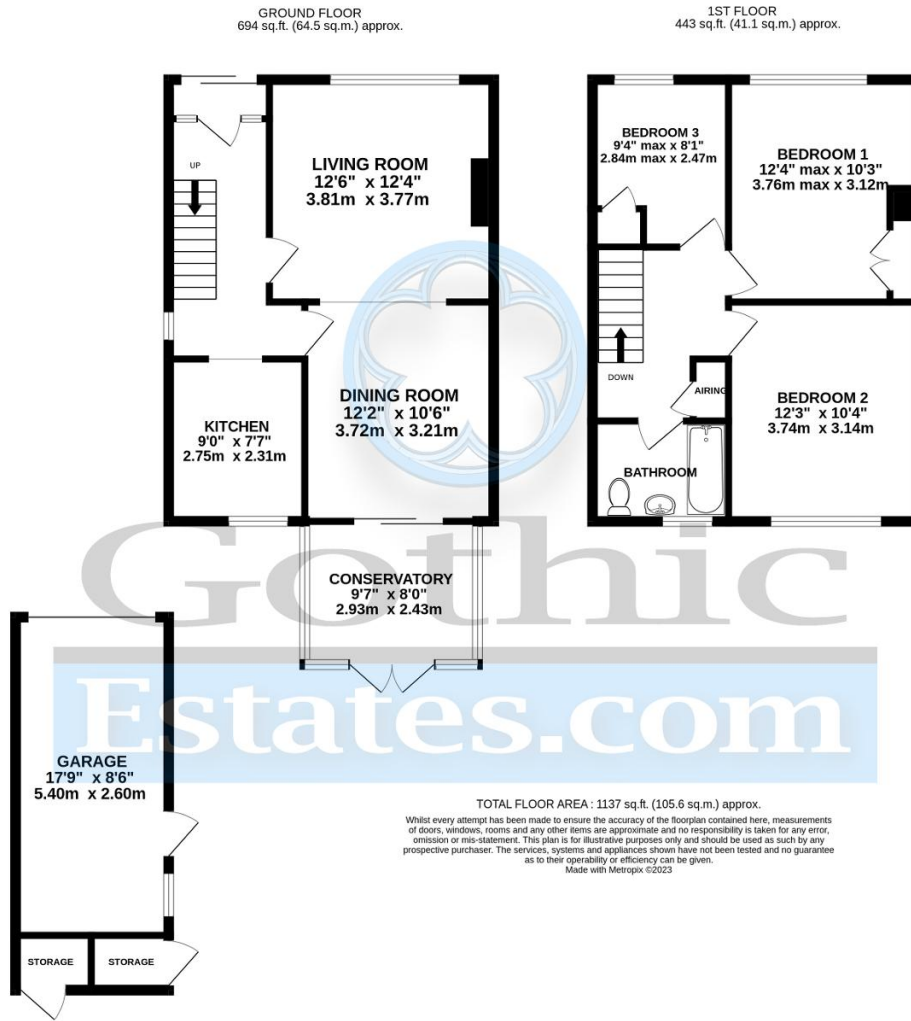

Energy Efficiency

